

MOBILE WASTE OIL DRAINER

L-0D90B



Thank you for purchasing a Lubemate L-0D90B waste oil drainer. The Lubemate Waste oil drainer is suitable for the collection and removal of waste oils only.

Filter Mesh Screen In Bowl
Catch foreign items.

Telescopic Suction Tube
Easy height adjustment.
Extends to 2.05m
(with Extender Bowl)

Waste Oil Level Tube
Identify oil level inside
holding tank.

Powder Coated Steel Tank
90L capacity.

Wide Bowl Extender
Large enough for automatic
transmission draining.
Extender diameter 600mm.

Oil Bowl
Diameter 400mm.

Offset Swiveling Bowl
For easy bowl positioning
Swiveling diameter up to 800mm.

Handy Tool Tray
Keep tools and accessories
within reach.

Polyurethane Wheels
Easier manoeuvring over
workshop floors.

TECHNICAL SPECIFICATIONS

- Gravity waste oil drainer
- Draining oil speed: 1.8 - 3LPM
- Suitable for draining waste oil from engines, gear boxes and differentials of all vehicles
- Tank capacity: 90L
- Max Drainer Capacity: 90L
- Oil Draining Pressure: 1 bar
- Maximum oil temperature: 120°C

Mac-rev-2-2020

IMPORTANT INFORMATION

The information contained will help ensure many years of dependable performance and trouble free operation. Please take a few moments to read through this instruction manual before operating your new L-OD90B waste oil drainer unit.



READ THIS INFORMATION CAREFULLY BEFORE USE.

Please retain this instruction manual for future reference.

Your safety is important to us. Please read and follow all instructions listed below. Some of these instructions alert you to the potential for personal injury.

“Cautions” throughout the manual advise of potential practices or procedures which may cause damage to your equipment.

Make sure all operators have access to adequate instructions about safe operating and maintenance procedures.

DO NOT exceed the maximum oil temperature of 120C.



WARNING!

Before attempting any repairs or maintenance of this product, disconnect the air supply to release the air pressure.

Do not extract brake fluid, caustic or flammable products.

DO NOT modify any component of this equipment.

ASSEMBLY PROCEDURE

1. Connect the wheels to the axle, tighten the screws. Insert the castors into the holes provided and tighten securely.
2. Insert the handle to the handle location tubes and tighten the screws securely.
3. Insert the gravity drain tube into the top hole on the container and tighten.
4. Attach the oil collecting pan to the top of the tube and tighten securely.
5. Insert the plastic strainer into the oil pan and fit the oil pan extender.
6. Attach the tool holder onto the brackets located on the top of the container.

OPERATION



WARNING!

Check the safety relief valve on the holding tank weekly for correct operation. The Safety valve should open at 1bar (14.5psi).

GRAVITY DRAIN USE

1. Open the ball valve located under the gravity drain.
2. Close the discharge ball valve located at the bottom of the holding tank.
3. Position the gravity bowl under the sump plug. Remove sump plug and drain the waste oil into the funnel.

EMPTY HOLDING TANK

The pressure relief valve is designed to open if the pressure in the holding tank exceeds 14.5psi. If the relief valve does not open, the valve is damaged and should be replaced.

1. Remove the air supply from the air inlet.
2. Close the ball valve located just below the gravity drain bowl.
3. Ensure that the ball valve on the bottom of the holding tank is closed.
4. Place the drain hose into a bulk waste oil tank.
5. Connect air to the air inlet on the holding tank to a pressure of 14psi (1bar) If the air pressure exceeds 14.5psi, the relief valve will open and will not close until a pressure of 14.5 psi or lower is reached.
6. Open the ball valve located on the bottom of the holding tank.

Note: The air will now push the waste oil out of the holding tank into the bulk waste oil tank. If you run out of air pressure repeat step 5.
7. After the oil transfer has been completed, release the air pressure in the holding tank and shut the holding tank ball valve.

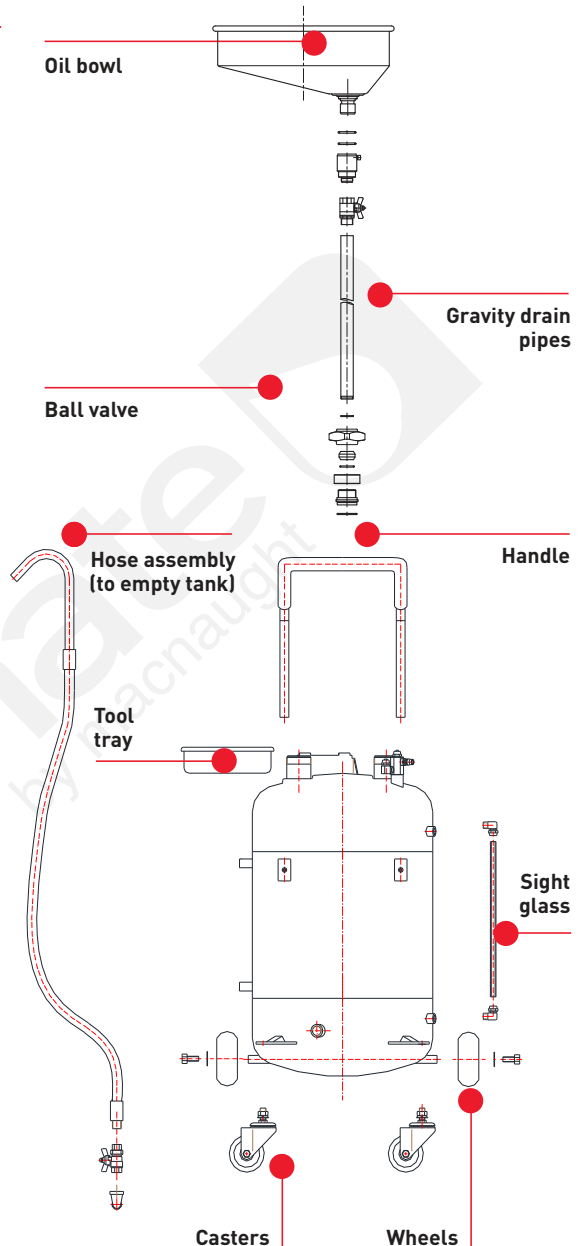

SPECIFICATIONS

Tank Capacity	90L
Max Drainer Capacity	90L
Drainer Oil Speed Capacity	1.8-3 L/min
Oil Draining Pressure	1 bar
Working pressure	6-8bar (87 -116 psi)
Max height (without extender bowl)	1.95m
Min height (without extender bowl)	1.21m
Max Height (with extender bowl)	2.05m
Min Height (with extender bowl)	1.31m

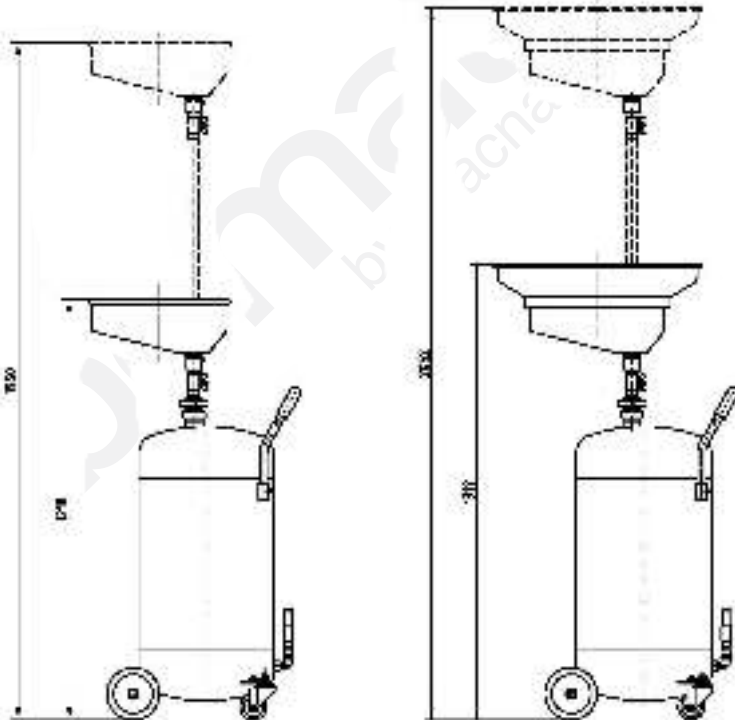

For Macnaught warranty, terms and conditions see macnaught.com/warranty ©Macnaught Pty Ltd, 2020



Lubemate® is a practical, cost-effective range of equipment brought to you by the trusted team at Macnaught.

All Lubemate products are specially selected by our experienced technical team at Macnaught®, ensuring they meet our strict quality standards.



Macnaught Pty Ltd

41-49 Henderson St, Turrella NSW 2205. Australia

Ph: 1800 185 102 **Fax:** +61 2 9597 7773

Email: info@macnaught.com **Website:** macnaught.com

NOTE: This product should be disposed of according to all applicable local and national government environment regulations and guidelines!

