



# PRODUCT DATA

## Metal SDS Flanged Hex Head and Seal

### Self Drilling Screw (SDS) #10-16

Applications	
•	Metal to metal fixing
•	Wall cladding
•	Sheds
•	Valley fixing

<b>Material</b>	 C1022 Hardened
-----------------	--

<b>Finish</b>	 Class 4
---------------	--

Pullout Values				
Plate (Purlin)	Metal Plate Thickness	<sup>1</sup> Mean Load	<sup>2</sup> Characteristic Load	<sup>3</sup> Working Load
	(mm)	(N)	(N)	(N)
G2	0.7	950	900	350
G2	1.1	1850	1600	650
G550	1.5	4000	3600	1450
G450	2.0	5250	4850	1950
G450	2.5	7150	6300	2500

## 10 Gauge Head Hex and Seal



Drill Point Test					
Plate (Purlin)	Metal Plate Thickness	Load	Drill Speed	Drill Time	Drill Time
	(mm)	(kg)	(RPM)	(Max. individual) Seconds	(Max. average) Seconds
G450	2.0	18	2200	4	3

Mechanical Properties				
Torsional Strength	<sup>1</sup> Mean Tensile Strength	<sup>1</sup> Mean Shear Strength	<sup>2</sup> Characteristic Tensile Strength	<sup>2</sup> Characteristic Shear Strength
(Nm)	(N)	(N)	(N)	(N)
6.9	12700	7600	11550	6950

Note: 1000N = 1kN

<sup>1</sup> Mean Load/Strength is the average ultimate strength of samples tested.

<sup>2</sup> Characteristic Load/Strength: 95% of these screws are expected to have a strength greater than the loads shown.

<sup>3</sup> Working Load is the governing minimum allowable load obtained by comparing relevant concrete and steel working loads. Factor of Safety (FOS=2.5 for steel, FOS=2.5 for timber and FOS=3.0 for concrete) are already included.

All values are obtained under laboratory conditions using DRILLX product. Safety factors should be considered for design purposes. Actual pullout loads may differ slightly depending on certain properties of the base material.

Disclaimer: While every reasonable effort has been made to ensure that this document is correct at the time of printing, Hobson Engineering®, its agencies and employees, disclaim any and all liability to any person in respect of anything or the consequences of anything done or omitted to be done in reliance upon the whole or any part of this document.



Bolt Tension | Anti-Vibration | Product Reliability | Traceability

[hobson.com.au](http://hobson.com.au) **QUALITY FASTENERS SINCE 1935**





# PRODUCT DATA

## Metal SDS Flanged Hex Head and Seal

Part	QFind	Gauge	TPI	Length	Thread Length	Drill Point Length	Head Height	Head ø	Drive Size	Pack Qty
				L (mm)	T (mm)	DP (mm)	H (mm)	D (mm)	AF (inch)	
T9PM4SH1016016	<b>Q275</b>	10	16	16	10	6.2	4.5	11	HEX 5/16"	1000
T9PM4SH1016022	<b>Q278</b>			22	14					1000
T9PM4SH1016025	<b>Q280</b>			25	19					1000

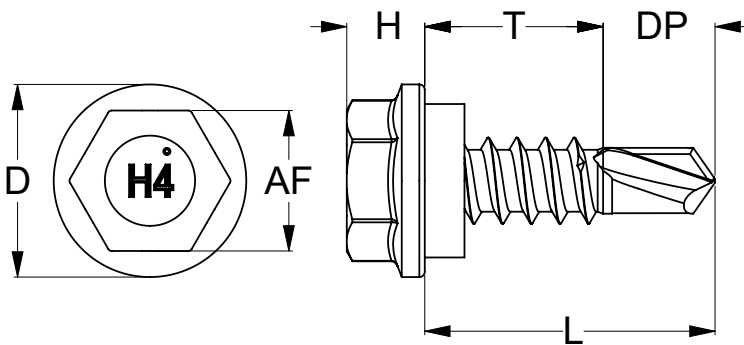

### Installation

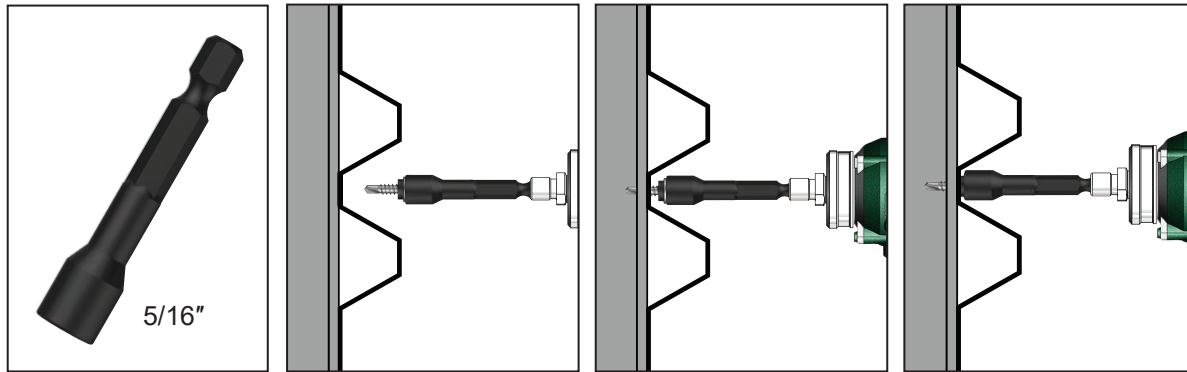

Recommended  
HEX 5/16 inch Drive Bit:

- TXDIPNSS31045 - 45mm
- TXDIPNSS31065 - 65mm
- TXDDPNSS31100 - 100mm
- TXDDPNSS31150 - 150mm
- TXDDPNSS31200 - 200mm
- TXDDPNSS31300 - 300mm

### Installation Guide

1. Use a cordless screw driver set between 2,200-3,000 RPM. Fit the HEX Drive Bit over the screw and place at the fastening position.
2. Apply consistently firm pressure to the screw driver while the screw is drilling.
3. Care should be taken not to overtighten the screw.

\*Installation with impact drivers not recommended.

Disclaimer: While every reasonable effort has been made to ensure that this document is correct at the time of printing, Hobson Engineering®, its agencies and employees, disclaim any and all liability to any person in respect of anything or the consequences of anything done or omitted to be done in reliance upon the whole or any part of this document.

Bolt Tension | Anti-Vibration | Product Reliability | Traceability

[hobson.com.au](http://hobson.com.au) **QUALITY FASTENERS SINCE 1935**

